

Lilac Grove Parkette Improvements

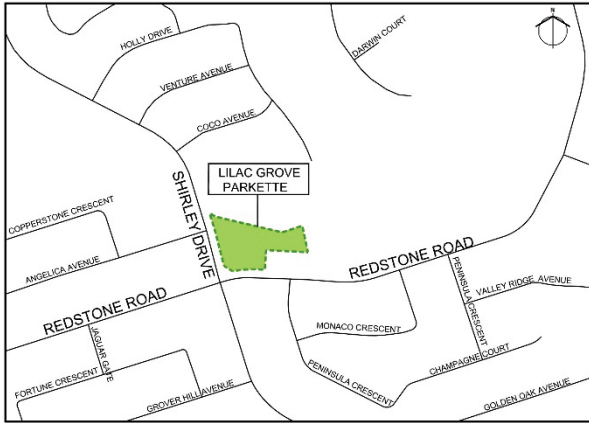

Playground Concept

Planned Construction Work

The City of Richmond Hill is improving the playground at Lilac Grove Parkette, this includes the replacement of the play equipment, safety surfacing, site furniture, some walkways, a new shade structure, and planting.

Park construction is scheduled to begin shortly and be completed by the end of June 2026, weather permitting. As a measure of safety, the park will be closed during construction and residents are asked to refrain from entering the park. Thank you in advance for your patience during the construction phase of this project.



For more information visit RichmondHill.ca/ParksProjects or scan this QR code. If you are unable to access the website, please contact the project lead.

<p>Contact/Project Lead: Kristina White, Project Manager T: 905-747-6397 E: Kristina.white@richmondhill.ca</p>	<p>Project Location: Lilac Grove Parkette – 251 Shirley Drive</p> <p>Website: RichmondHill.ca/ParksProjects</p>
<p>Inspector: Dereje Tafesse, Senior Municipal Inspector T: 905-747-6596 E: dereje.tafesse@richmondhill.ca</p>	<p>Park Contractor: Lyncon Construction Inc. Infrastructure and Engineering Services Department Infrastructure Delivery Division</p>